

## NanoPro™ B-4030

### Base Stable Membrane Data Sheet

#### Product description

<b>Membrane Chemistry:</b>	Polyethersulfone
<b>Membrane Type:</b>	Base Stable Nanofiltration Membrane 8040 Spiral Wound Element
<b>Construction*:</b>	Feed Spacer (diamond): 31 mil, 46 mil Permeate Tube: Polysulfone

\*For special requests, please contact AMS

#### Specifications

Model	Rejection %	Pure Water Flux LMH (GFD)	Membrane Area m <sup>2</sup> (ft <sup>2</sup> )	Feed Spacer mil
	Na <sub>2</sub> SO <sub>4</sub>			
B-4030-8040-31P	35-75	>200 (118)	32 (344)	31
B-4030-8040-46P			25 (269)	46

Test Conditions: 40 bar (580 psi); 20°C (68°F); Stirred cell (700 rpm).

### Operating Information (\*)

---

Maximum Operating Pressure:	40 bar (580 psi)
Maximum Operating Temperature:	80°C (176°F)
Maximum Cleaning Temperature:	80°C (176°F)
Allowable pH – Continuous Operation:	3-14
Allowable pH – Clean in Place (CIP):	2-14
Maximum Pressure Drop per Element:	0.5 bar (7.2 psi)
Recirculation Flow Rate	25-40 m <sup>3</sup> /h

---

(\*) Consult AMS Technologies for specific information

### Recommended cleaning materials

- Use deionised water to wash the element. Use alkaline cleaner to clean organic contamination; use acidic cleaner to clean inorganic contamination.

### Nominal Product Dimensions

For 8040:

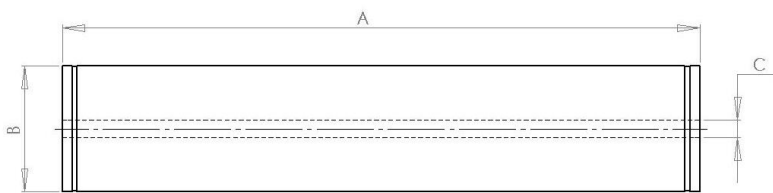

Size	A	B	C
	mm (inches)	mm (inches)	mm (inches)
8040	1016 (40)	200.5 (7.9)	30.15 (1.19) - ID

### **Lubricants:**

For element installation, use glycerin to lubricate seals. The use of petroleum or vegetable-based oils or solvents may damage the element and void any warranty.

### **Other**

- Do not expose the membrane to chlorine or other oxidants.
- Sodium metabisulfite (without catalysts such as cobalt) is the preferred chemical to eliminate free chlorine or other oxidizers in the feed.